

GLYNN-JOHNSON®

450 Series

Door controls

Glynn-Johnson provides the most complete line of overhead holders and stops, offering solutions for the most demanding door control problems.

Glynn-Johnson 450 Series holders and stops provide versatile surface-mounted overhead door control for all medium to light-duty applications.

The 450 Series holders and stops are designed for installation in virtually all types of doors and frames including doors with conventional butt hinges, off set pivots, continuous hinges, swing clear hinges and many other speciality hinges. The templates provided allow for variable mounting positions, ranging from 85° - 110° of opening.



Features

- Holds open at predetermined positions, permitting unobstructed traffic flow
- Adjustable hold open tension option
- Five track lengths to suit doors opening from 457mm to 1145mm
- Suitable for single acting exterior and interior doors, easy to install
- Templating suitable for doors opening from 85° to 110°
- Refer to fitting instructions for set-out details
- Non-handed

Warranties	
Mechanical	30 years
Finish	allegion.co.nz/finisheswarranty

Specification guide

Series	Function	Finish
457mm - 584mm door opening. *GJ451	Friction F	Satin Chrome plate SCP
585mm - 685mm door opening. GJ452	Hold open HO	
681mm - 830mm door opening. GJ453	Stop only SO	
838mm - 990mm door opening. GJ454		
990mm - 1145mm door opening. *GJ455		

- Model**
Select the desired series GJ453
- Function**
Select the required function e.g., hold open GJ453HO
- Finish**
Select the desired finish e.g., satin chrome plate GJ453HOSCP

*Available in friction only

Finish



SCP

Satin Chrome Plate

Specifications

Door type	Timber or metal
Door thickness	35mm to 57mm
Door width	457mm - 1145mm
Fixings	Sexbolts for channel attachment to the door
Material	Steel

Standard jamb bracket

Mounting dimension B must be determined from the chart included with the installation instructions.

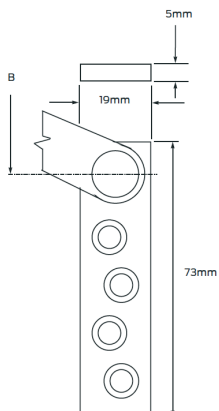

Angle jamb bracket

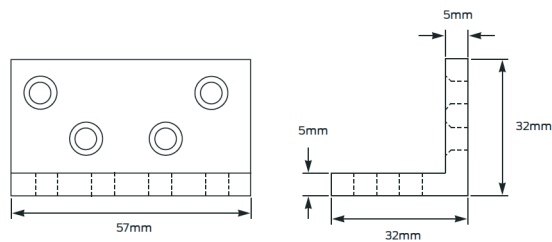

Note: It is recommended that metal door frames be reinforced where the jamb bracket is attached.

Mounting details

Mounting dimension A, B, and C must be determined from the chart included with the installation instructions.

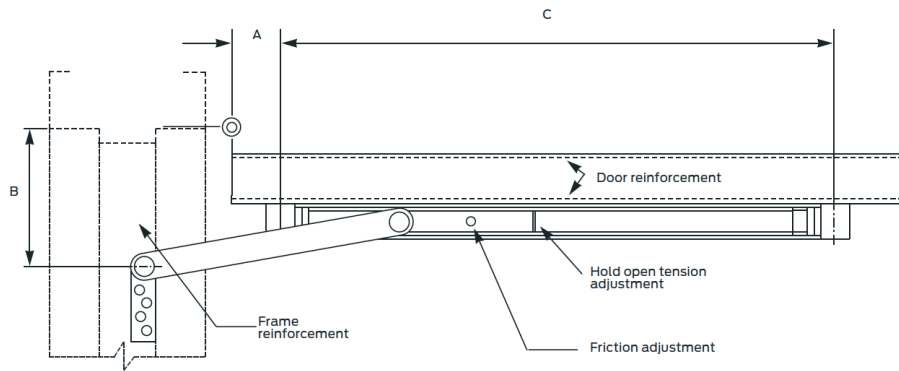

Cross section in closed position

